

Drawing Info. NETHERLEE & STAMPERLAND ON-STREET WAITING AND LOADING RESTRICTIONS:

- Schedule 1- No Waiting and No Loading at Any Time
- Schedule 2- No Waiting at Any Time
- Schedule 3- No Waiting at Any Time and No Loading 8-9:30am and 4:30-6pm Monday-Saturday
- Schedule 4- Waiting Limited to 60 Minutes with no return within 60 minutes 9am-5pm Monday-Friday
- Schedule 5- No Waiting 8am-6pm Monday to Friday
- Pedestrian Crossing (Indicative location only - does not form part of the Order)
- Bus Stop (Indicative location only - does not form part of the Order)

EAST RENFREWSHIRE COUNCIL - ENVIRONMENT DEPARTMENT
 Roads Service - 2 Spiersbridge Way, Spiersbridge Business Park, Thornliebank, G46 8NG
 Head of Environmental Services & Roads - Andrew Corry

| | | | | | |
|----------------------|--|-------------------|-------|--------------|--------------|
| Drawing Title | The East Renfrewshire Council (Netherlee & Stamperland) (On-Street) (Waiting and Loading) Order 2016 | Dwg By | NM | Date | Sept 2016 |
| Dwg No. | Page 1 of 2 | Checked By | SCALE | Scale | NOT TO SCALE |
| File Ref. | ER-58-40-321 | Rev. | 12 | PD | |



Reproduced from the Ordnance Survey Mapping with the permission of Her Majesty's Stationary Office (C) Crown Copyright. Unauthorised reproduction infringes Crown Copyright and may lead to prosecution or civil proceedings. ERC Licence No. (c) Crown Copyright. 100023382 2016.

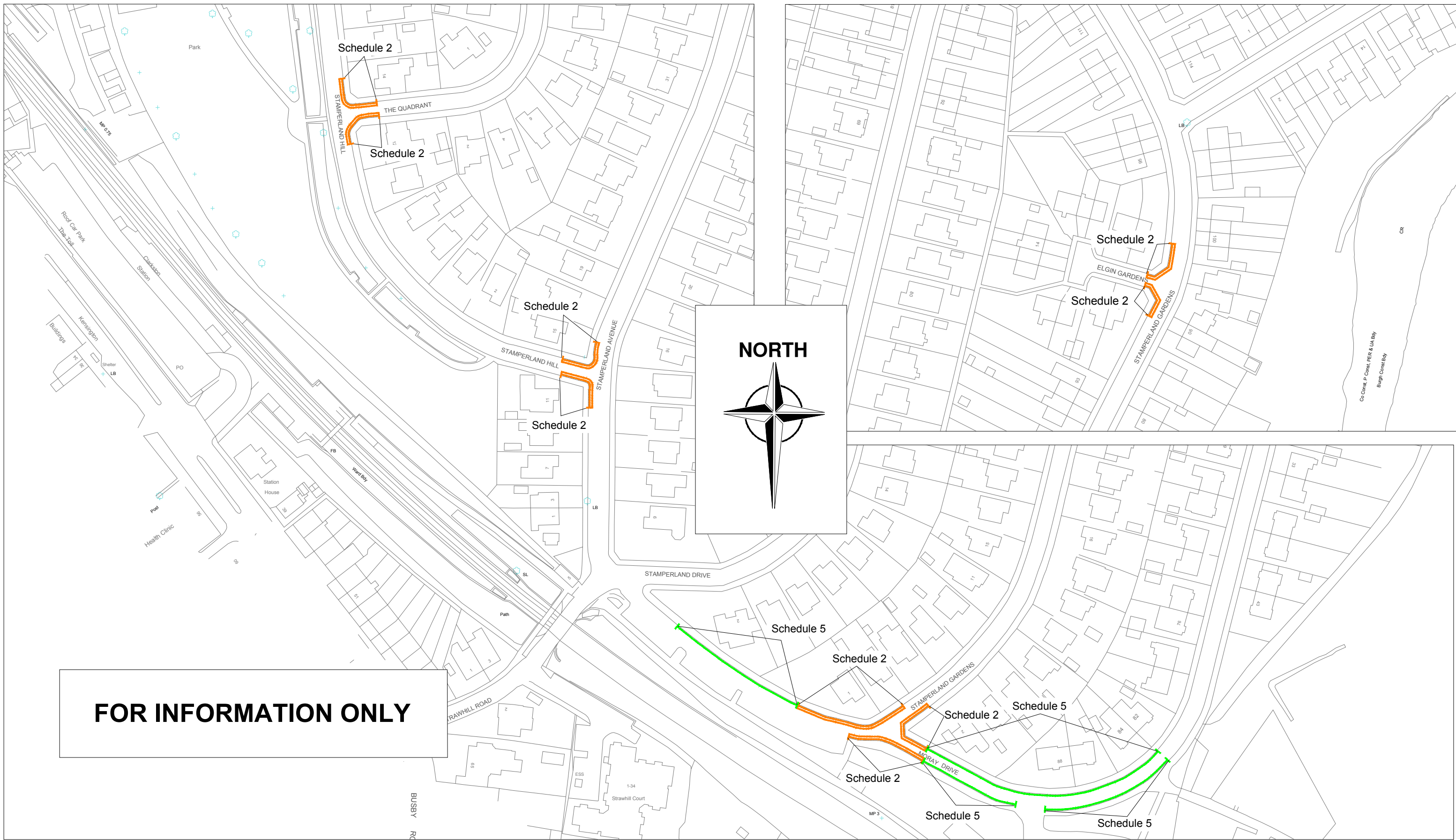

FOR INFORMATION ONLY

Drawing Info. **NETHERLEE & STAMPERLAND- ON-STREET WAITING AND LOADING RESTRICTIONS:**

- Schedule 2- No Waiting at Any Time
- Schedule 5 - No Waiting 8am to 6pm Monday to Friday

EAST RENFREWSHIRE COUNCIL - ENVIRONMENT DEPARTMENT
 Roads Service - 2 Spiersbridge Way, Spiersbridge Business Park, Thornliebank, G46 8NG
 Head of Service - A. Corry

Drawing Title The East Renfrewshire Council
 (Netherlee & Stamperland)
 (On-Street) (Waiting and Loading) Order 2016

Dwg No. Page 2 of 2
File Ref. ER-58-40-321

Rev. 12
Checked By PD

Dwg By NM
Date Sept 2016
Scale Not to scale

